

For Sale

Prime Development Property

HOTEL, RESTAURANT OR RETAIL SITES

I-30 & Cowhorn Creek - Texarkana, TX



PRIME DEVELOPMENT LAND

7+ acres of development land

- Prime Development Land
- I-30 Frontage
- Neighbors include:
Central Mall
Hotels
Restaurants

Asking Price:
\$12-16/sf depending on site

Additional Land Available

For Further Information:

Jerry Brewer

903.793.2666 office • 903.793.3094 fax
jerry@amreal.com • www.amreal.com

NAI American Realty Company
Commercial Real Estate Services, Worldwide.

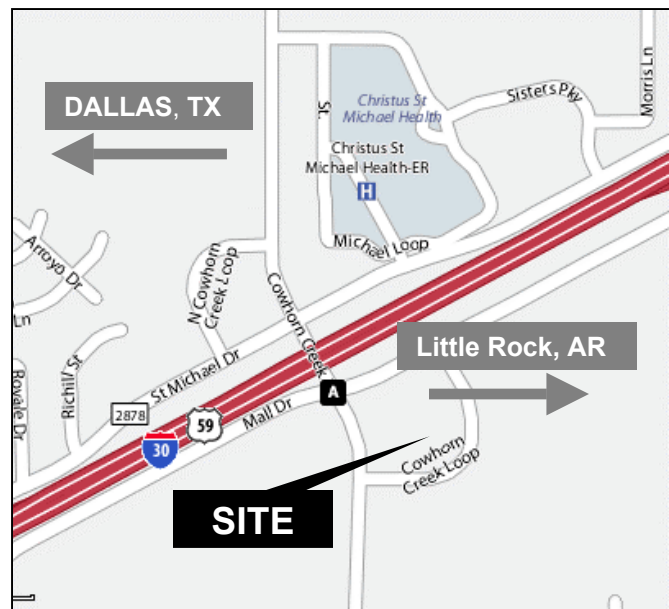

SITE PLAN

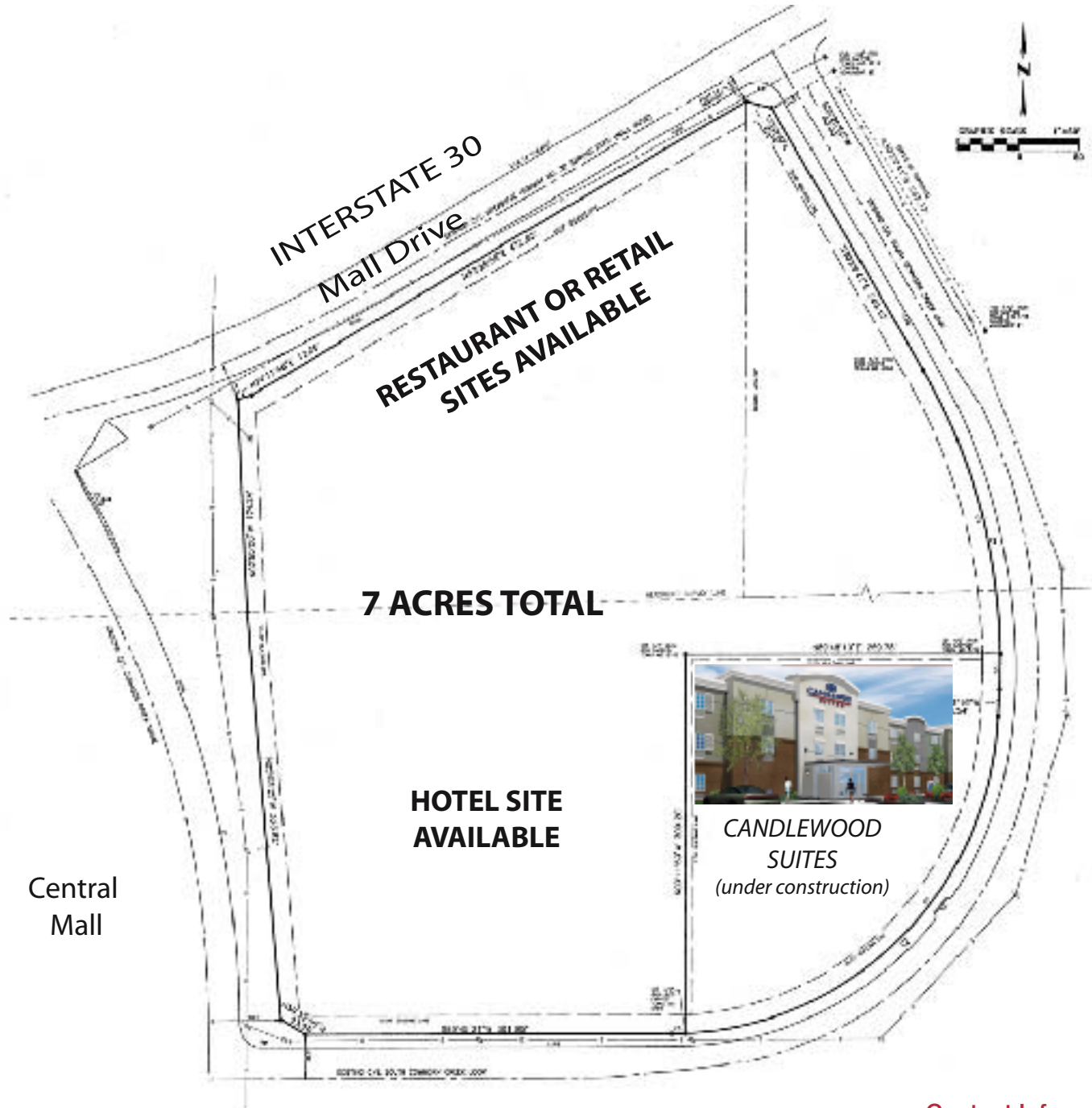

Contact Information:

Jerry Brewer

Office 903 793 2666/Cell 903 691 0941

Fax 903 793 3094

jerry@amreal.com/www.amreal.com

NAI American Realty Company
Commercial Real Estate Services, Worldwide